



Trinity College Dublin  
Coláiste na Tríonóide, Baile Átha Cliath  
The University of Dublin

Trinity  
Innovation  
& Enterprise

# Discover Your Space

Where industry, innovation, and research meet



**Guide to Trinity Innovation & Enterprise Meetings & Events Spaces**



# Welcome

Trinity Innovation & Enterprise provides the physical engine for Dublin's most vibrant innovation community. By choosing our venues, you are placing yourself at the intersection of world-class research, industry leadership, and entrepreneurial energy. Our spaces are designed to foster collaboration, ignite creativity, and provide a professional, high-impact environment for any occasion.

## **Trinity Innovation Hub at Trinity East**

Our high-energy flagship positioned at the very heart of Dublin's vibrant and tech-driven Silicon Docks offering more than just a space but an opportunity to be a part of the innovation ecosystem.



## **Trinity Innovation Workspace at Trinity Business School**

A premier, high-tech space located in central Dublin, offering world-class facilities within our award-winning, sustainable campus.



## **Unit 18 at Trinity East**

Our versatile, ground-floor space in Trinity East, designed to be the bridge between global innovation and local community engagement.





# The Innovation Hub at Trinity East

A dynamic hub uniting thinkers, doers and disruptors. A space designed for collaborative events, high-energy workshops, innovation team environments and networking opportunities in Grand Canal Dock, the heart of Dublin's Silicon Docks.

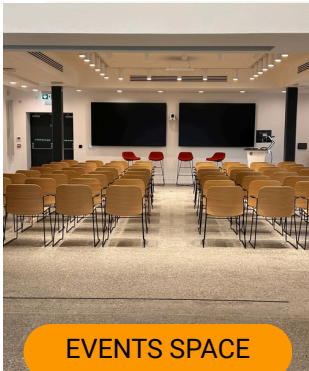

EVENTS SPACE

## Events Space

Capacity: 70 (Theatre Style), 48 (Workshop)

- 2 x 98" Screens
- 2 mounted Cameras, (presenter and room facing)
- Videoconferencing available
- AV System (4 lapels, 2 hand-held microphones)
- Meeting rooms available for breakout sessions
- Adjacent exhibition space available at full day rate
- of €700 + VAT

**€850 + VAT**  
(full day)

**€600 + VAT**  
(half-day)

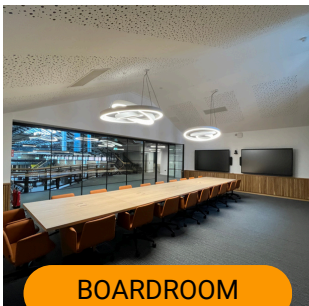

BOARDROOM

## Boardroom

Capacity: 20 people

- 2 x 86" Clevertouch interactive touchscreens
- In-built PC and dual screens
- Videoconferencing available
- HDMI connection possible
- Catering permitted in the boardroom mezzanine

**€600 + VAT**  
(full day)

**€450 + VAT**  
(half-day)



MEETING ROOM

## Large ThinkTank Meeting Room (6 people)

Capacity: 6 people

Rooms: 8 large meeting rooms

- 65" wall-mounted screen
- 4 of the 8 rooms are suitable for videoconferencing
- Catering not permitted in the room

For hybrid meetings, please inform us in advance to arrange a room with in-built PC and videoconferencing

**€200 + VAT**  
(full day)

**€125 + VAT**  
(half-day)



MEETING ROOM

## Small ThinkTank Meeting Room (3 people)

Capacity: 3 people

Rooms: 4 small meeting rooms

- Four smaller meeting rooms available upon request
- Compact setup suitable for up to 3 people
- Catering not permitted in the room

**€150 + VAT**  
(full day)

**€100 + VAT**  
(half-day)

Full day: 0930-1730h. Half day: 0900-1300h/1400-1730h.  
Evening out-of-hours available 1830-2130h subject to supplement. Price on request.

**Ready to book?**

**ENQUIRE NOW**



# The Innovation Hub Floor Plans



Ground Floor - ThinkTank Meeting Rooms Location

## Ground Floor

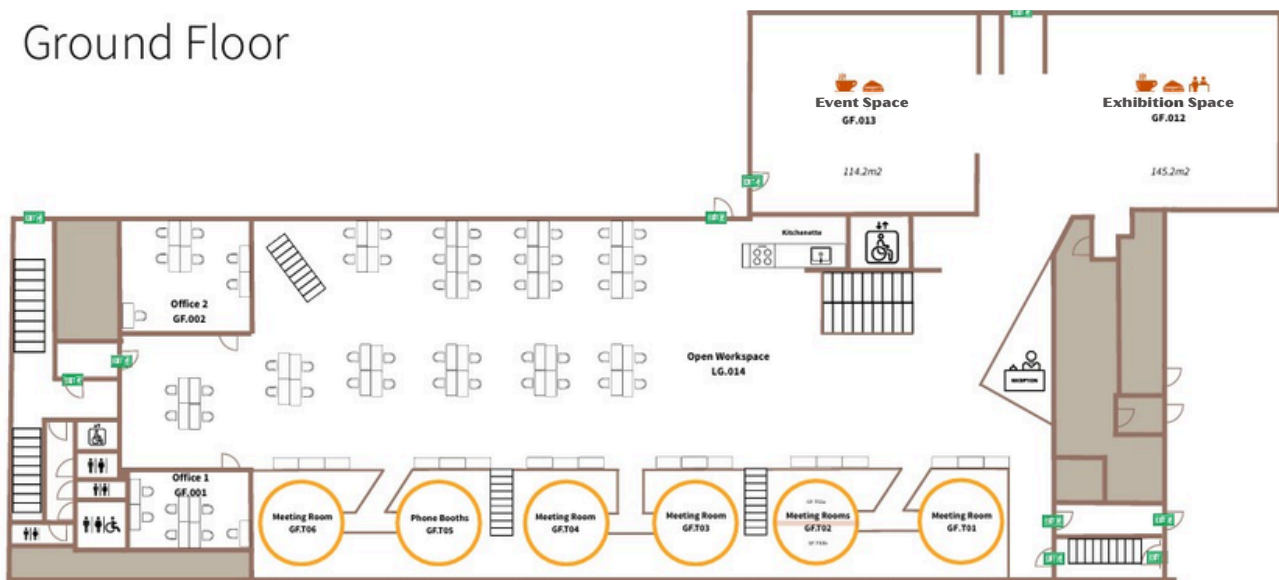

Areas unusable for events or restricted zones



Ground Floor - Event Space



Ground Floor - Exhibition Space

Additional Meeting Rooms on Lower Ground Floor and Boardroom on Mezzanine.



# Find your way to Trinity's Innovation Hub

## Trinity's Innovation Hub

Address: 4 Grand Canal Quay, Dublin 2, D02 HR22

The new Innovation Hub is located on Grand Canal, across from Bolands Mills. As you approach the Grand Canal Bridge from Pearse St, with the city centre behind you, turn right onto Grand Canal Quay and the building is on your right hand side.

To find us on Google Maps, use this link: [Click here](#) or search the following Eircode:

**D02 HR22**

For convenience, you can scan the QR code to open the exact location on Google Maps.

Please note that no parking is available on site. In exceptional circumstances, limited access may be possible, but requests must be made in advance by emailing [portal@tcd.ie](mailto:portal@tcd.ie).

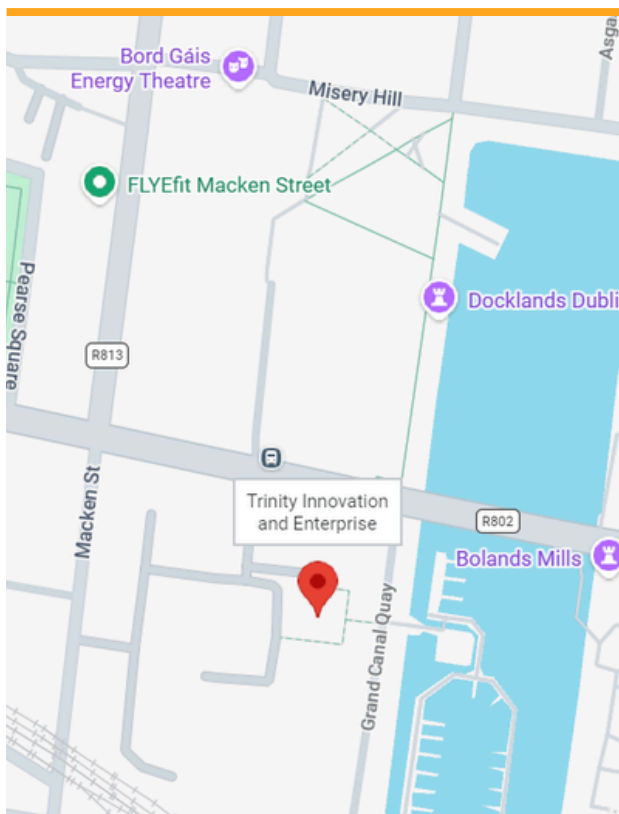

Trinity's Innovation Hub - Building Entrance



# Innovation Workspace at Trinity Business School

Located within the award-winning Trinity Business School, this Innovation Workspace offers a high-tech environment ideal for large-scale conferences and executive workshops.



**MAIN SPACE**

## Main Space

### 1st Floor, Trinity Business School

Capacity: 150 (Theatre) / 100 (Workshop) / 180 (Reception)

- Led screen (32:9, 7 x 1.9 metres)
- Multiple mics & speakers
- Video conferencing cameras
- Flexible layouts
- Full catering permitted — to be arranged by the hirer

**€1.800 + VAT**  
(half-day)

**€3.000 + VAT**  
(full day)



**CLASSROOM**

## Classroom 115

### 1st Floor, Trinity Business School

Capacity: 42 (Workshop Style)

- In-built PC
- Double screen (32:9 aspect ratio, 2 x 4K HD)
- Video conferencing cameras
- 2 whiteboards
- Tea/coffee service permitted — to be arranged by the hirer

**€400 + VAT**  
(half-day)

**€600+ VAT**  
(full day)



**CLASSROOM**

## Classroom 119

### 1st Floor, Trinity Business School

Capacity: 42 (Workshop Style)

- In-built PC
- Double screen (32:9 aspect ratio, 2 x 4K HD)
- Video conferencing cameras
- 2 whiteboards
- Tea/coffee service permitted — to be arranged by the hirer

**€400 + VAT**  
(half-day)

**€600 + VAT**  
(full day)

Full day: 0930-1730h. Half day: 0900-1300h/1400-1730h.  
Evening out-of-hours available 1830-2130h subject to supplement. Price on request.

**Ready to book?**

**SEND AN ENQUIRY**



# The Innovation Workspace Floor Plans

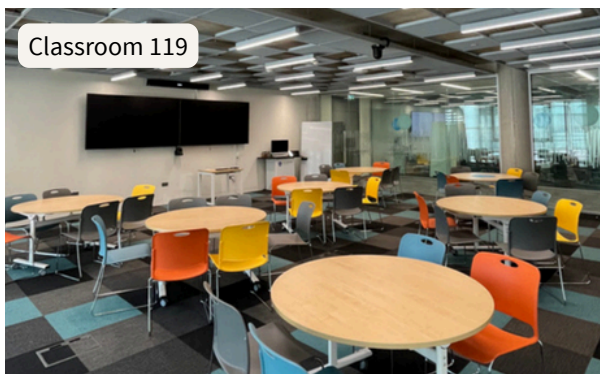
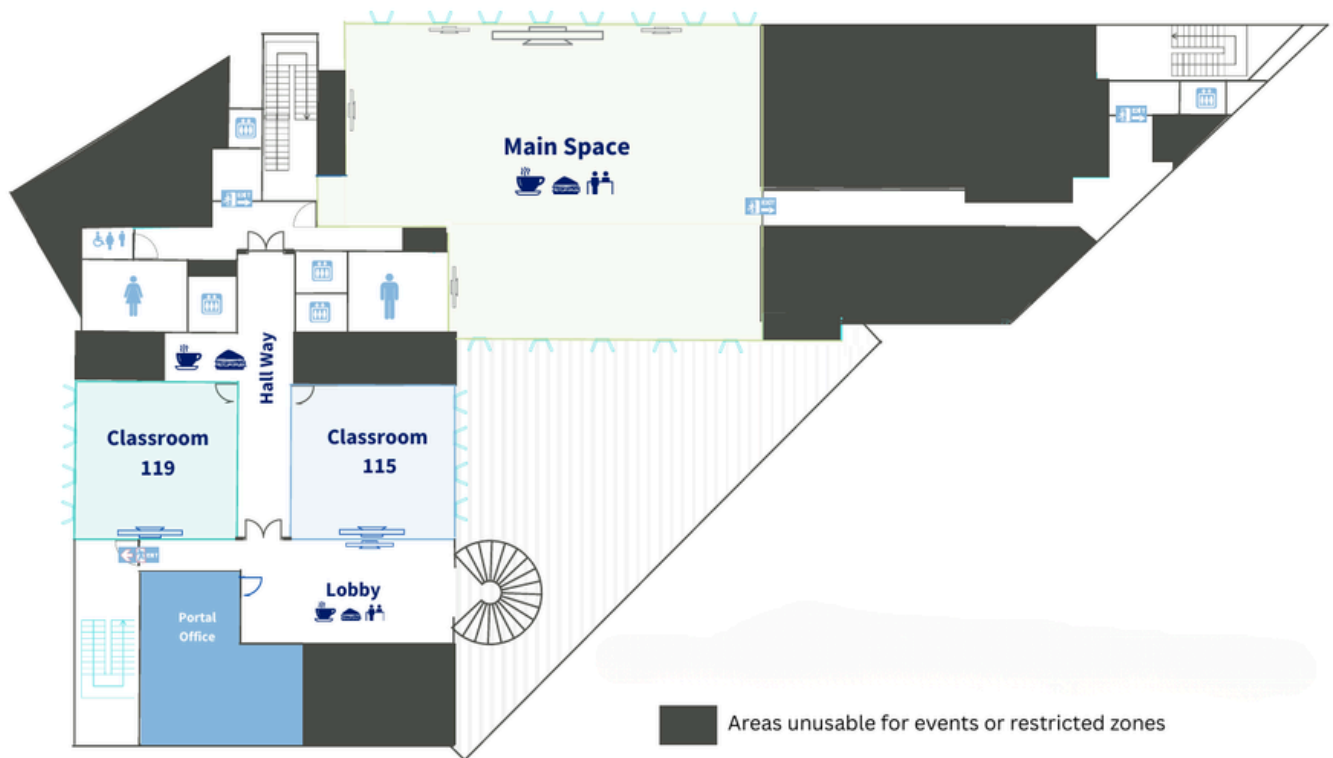
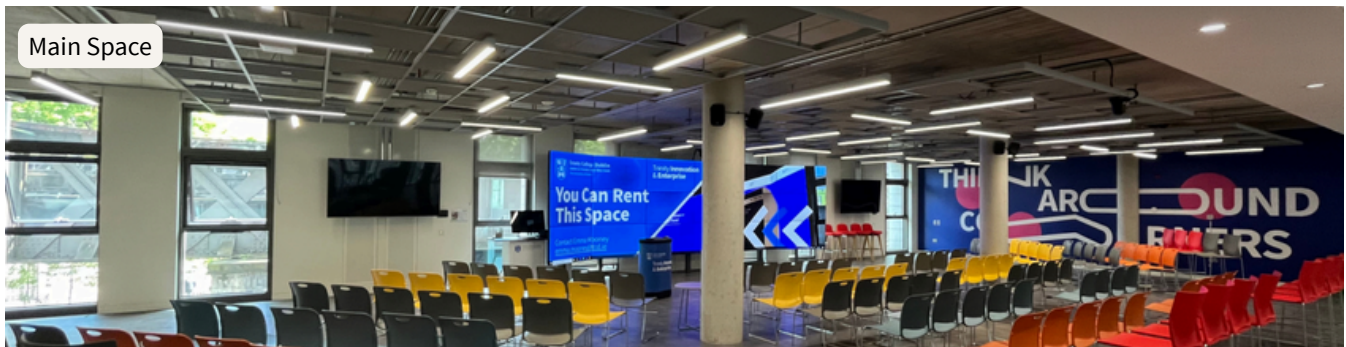



# Find your way to the Innovation Workspace at Trinity Business School

## Trinity's Innovation Workspace

Address: 182 Pearse Street, Dublin 2, D02 F6N2

Located in Trinity Business School on the 1<sup>st</sup> floor, the Innovation Workspace can be accessed from within Trinity College campus or via the entrance on Pearse Street.

To find us on Google Maps, use this link: [Click here](#) or search the following Eircode:

**D02 F6N2**

For convenience, you can scan the QR code to open the exact location on Google Maps.

Please note that no parking is available on site. In exceptional circumstances, limited access may be possible, but requests must be made in advance by emailing [portal@tcd.ie](mailto:portal@tcd.ie).

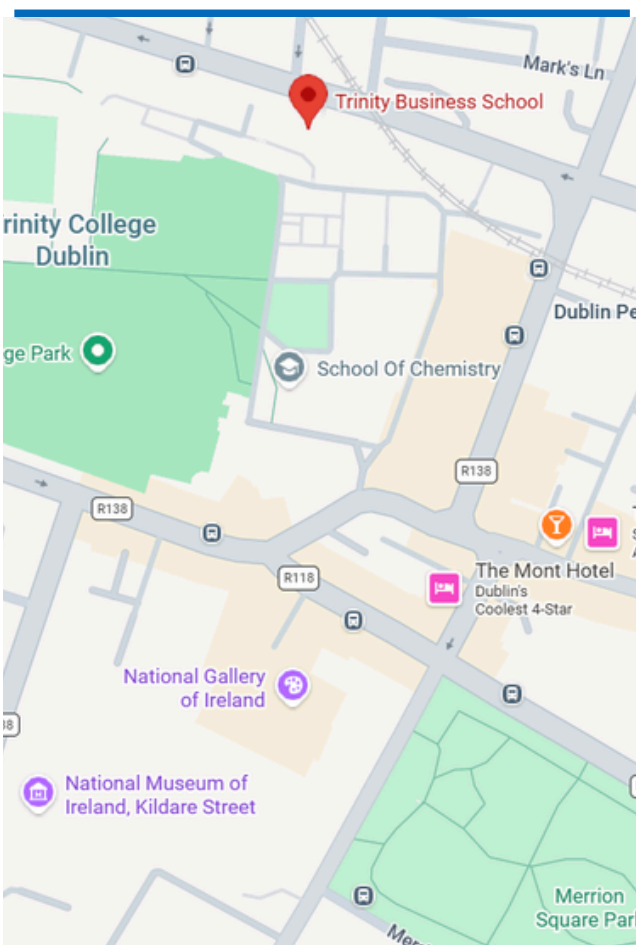

Trinity's Innovation Workspace - Street Entrance



## Unit18 at Trinity East

Located on the Trinity East campus, this space is designed as a place for local residents of all ages and backgrounds to meet, learn, socialise and have fun. Since opening this 300+ square metre ground-floor unit, we have continued to welcome new and diverse groups and co-develop new programmes.



### Unit18 Vision

The vision for Unit18, working in partnership with stakeholders on the Trinity East site and within the wider local community, is to deliver social, cultural, education and economic benefits to residents in the area, focusing on three key strands – Employment, Education and Skills; Arts and Culture; and Civic and Community

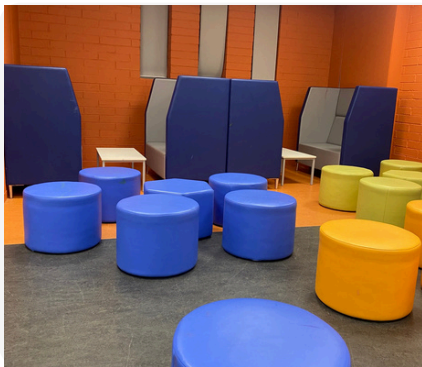

The multipurpose space is available to rent on a half day or full day basis.

Full day: 0930-1730h.

Half day: 0900-1300h/1400-1730h.

Evening out-of-hours available 1830-2130h subject to supplement. Price on request.

**€300 + VAT**  
(half-day)

**€500 + VAT**  
(full day)



### Events & Activities

Programmes taking place at Unit18 and groups that are using the space include:

- Talk with Trinity – a programme of public talks on everything from health to history.
- Digital skills for older people
- Crafty Creatures– knitting and crochet group
- Extinction Rebellion art group
- Failte Isteach English conversation classes
- St Vincent de Paul- food bank and committee meetings
- Talk about Youth Programme, St Andrew’s Resource Centre

**Ready to book?**

**ENQUIRE NOW**



# Find your way to Unit18 at Trinity East

## Unit18 at Trinity East

Address: Macken Street, Dublin 2, D02 VE83

The front door is located on Macken Street, approximately 50 metres from the junction of Pearse and Macken Street, going towards Grand Canal Street Lower (black gates with sign).

To find us on Google Maps, use this link: [Click here](#) or search the following Eircode: **D02 VE83**

For convenience, you can scan the QR code to open the exact location on Google Maps.

Please note that no parking is available on site. To enquire about using Unit18, email Mary Colclough, Community Engagement Manager: [unit18@tcd.ie](mailto:unit18@tcd.ie)

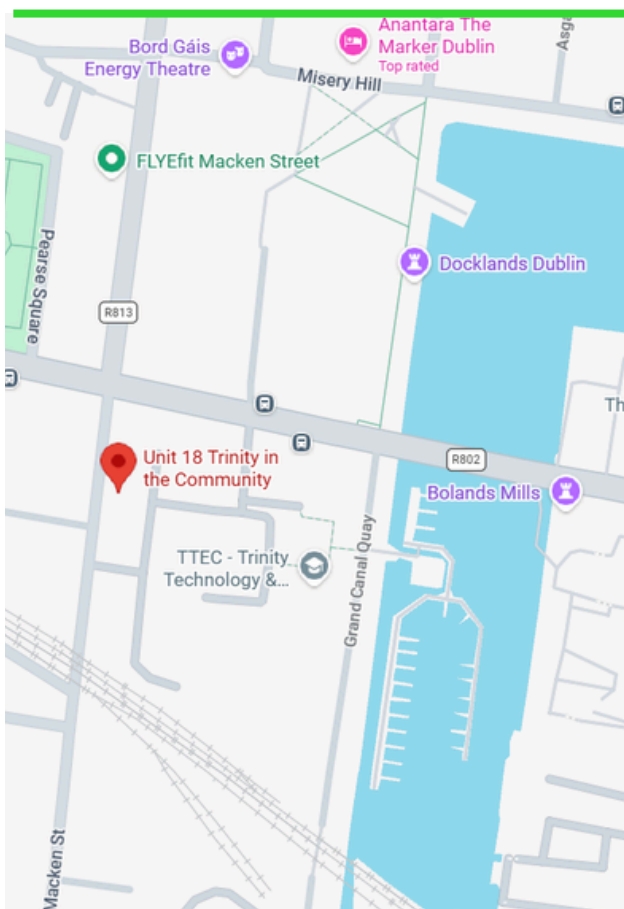

Unit18 at Trinity East - Street Entrance



# Terms & Conditions

## Rates:

The rates listed herein apply to the use of the facilities and include room set-up, as well as access to all in-situ audio-visual equipment and furniture. Rates are fixed and do not vary based on attendee numbers.

A half-day booking runs from 9:00 a.m. to 1:00 p.m. or 1:30 p.m. to 5:30 p.m. A full-day booking runs from 9:00 a.m. to 5:30 p.m.

Evening hours 6:30 pm to 9:30 pm. Additional rates may be applied for events support staff for out of hours, please contact us for a quotation.

## VAT (Value Added Tax):

VAT will be applied at the prevailing rate, at date of invoice. Currently conference fees are subject to 23% VAT.

## Price Variation:

Although every effort will be made to maintain the price quoted, Trinity Innovation & Enterprise reserves the right to alter its tariff should circumstances compel such action. It will however give notice of any such intended change. Quoted rates apply for 2025/26 only.

## Deposits:

A non-refundable deposit will be required before a conference/room booking is accepted as firm and guaranteed by Trinity Innovation & Enterprise. This will be 50% of the estimated total cost. A balancing invoice will be issued no later than 24hrs after the event.

Payment is due within 2 weeks. Unpaid fees may impact upon booker's ability to hire space again in the future.

## Payment:

Payments must be made in accordance with the Terms and Conditions printed on the invoice. Credit Cards are not currently accepted by Trinity Innovation & Enterprise. Payments will incur a payment charge of 3.5% on top of the gross amount charged.

## Cancellation:

- Cancellation over 4 weeks prior to the event - 50% of total charge
- Cancellation under 2 weeks prior to the event - 100% of total charge
- Notice of all changes must be submitted in writing to Trinity Innovation & Enterprise.

## Insurance:

The hirer must hold and produce evidence of insurance to Trinity Innovation & Enterprise for Public Liability insurance with a limit of €6,500,000 extended to provide an indemnity to Trinity Innovation & Enterprise, Trinity College to include cover for damage to property in the custody and control of the hirer. Trinity Innovation & Enterprise, Trinity College will be indemnified by the hirer in respect of his suppliers, agents or other third parties introduced by the hirer.

## Disclaimer:

Trinity Innovation & Enterprise, Trinity College shall not be liable for any loss or damage suffered by hirers of

facilities which arises from any untoward interference with the College premises or personnel, whether such interference is caused by fire, force majeure, industrial dispute, political intimidation or commotion, or by any cause not reasonably within the power of the College to anticipate or remedy.

The College deserves the right to deal solely with principals and reserves its right to decline to deal with agents.



Trinity College Dublin  
Coláiste na Tríonóide, Baile Átha Cliath  
The University of Dublin

Trinity  
Innovation  
& Enterprise

Bringing Tradition  
and Technology:  
Innovating in Food Banking to  
Build Resilient Communities

CEO and

# Let's build your next event together.

Whether you're planning a workshop, hosting a talk, or delivering a full-day conference, we'd be delighted to support your next event. From flexible room layouts to on-site assistance, our team is here to help you bring your vision to life.

[ENQUIRE NOW](#)